



kate

reality



1974 Arthur Highway Copping TAS

3 2 30

Approximately 100 acres, with spacious family home and an abundance of farming infrastructure.

This north facing, country lifestyle package enjoys total privacy, while overlooking prime farming land with a view of the world going by. It is conveniently located only 15 mins from Sorell, 25 mins from Hobart airport and 45 mins from Hobart.

Silver Birches line the drive up to an Immaculately presented homestead featuring a warm Tas Oak kitchen. The open-plan kitchen/dining/lounge with cosy wood heating makes the heart of the home. Glass sliding doors open out onto the verandah and into a large country style pantry ideal for all your preserves and stores.

The West facing wing includes a generous formal lounge

Building Size : 272 sqm
Land Size : 39.58 ha
View : <https://www.katestoreyrealty.com.au/sale/tas/hobart-southern/copping/residential/house/6770755>



Kate Storey
03 6253 6095

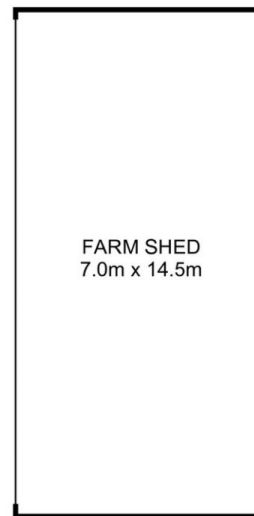
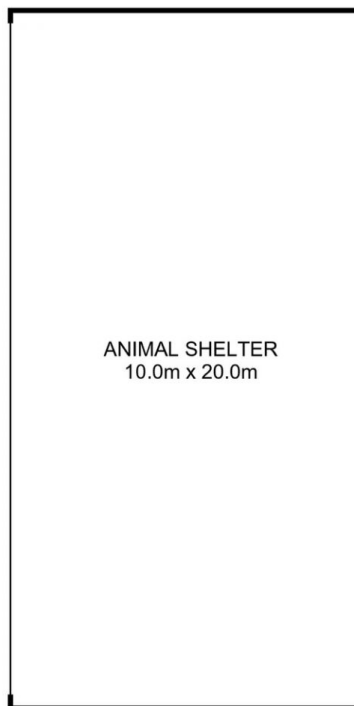
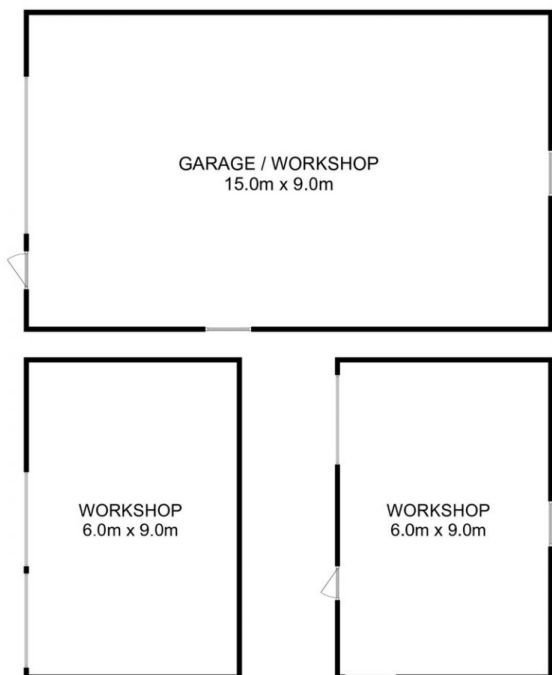

Total Approx. Outbuilding Area : 545 sqm



All measurements are internal and approximate.
This plan is a sketch for illustration, not valuation.
Produced by Open2view.com

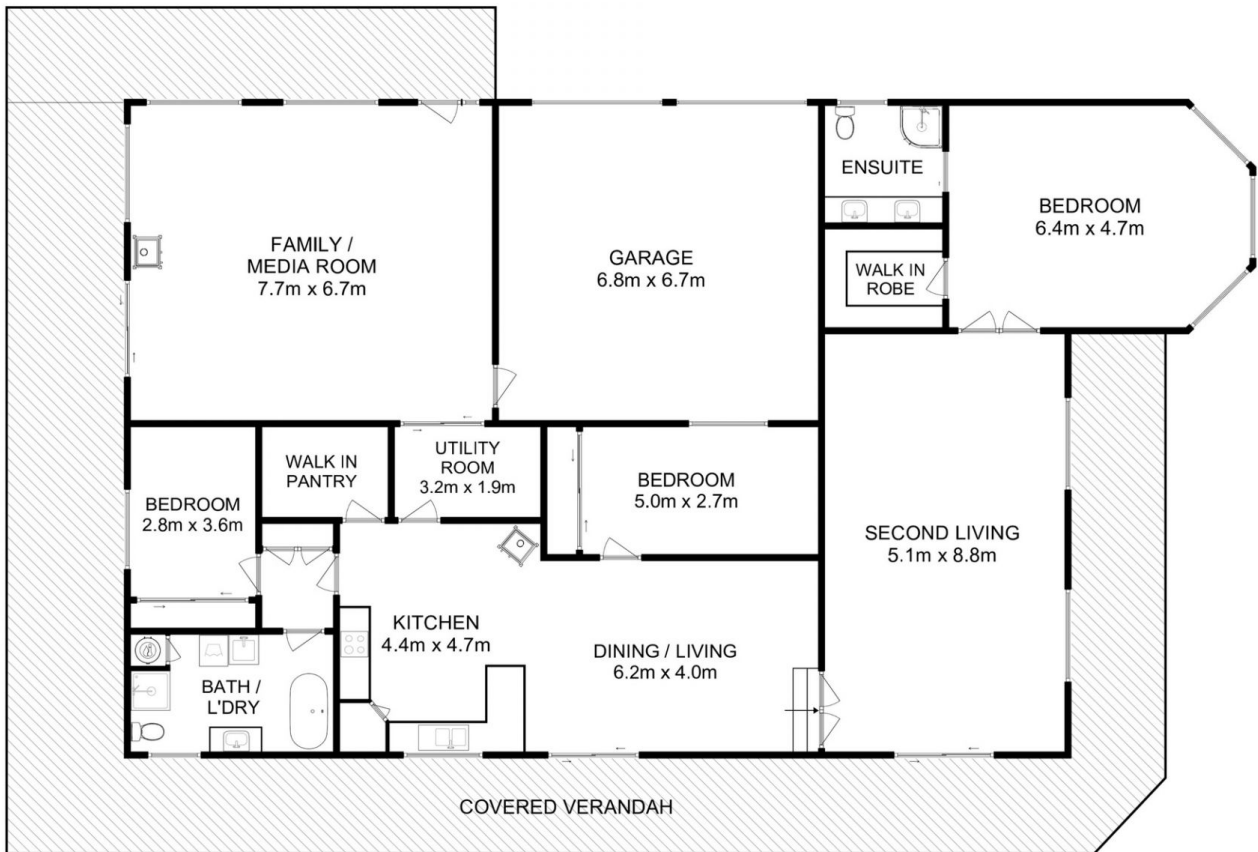

Total Approx. Floor Area (inc. Garage) : 296 sqm

All measurements are internal and approximate.
 This plan is a sketch for illustration, not valuation.
 Produced by Open2view.com

